



# MEC TECH<sup>®</sup>

Your Technical Partner

## MEC Tech Corporation Ltd.

IS A PRE-ENGINEERED BUILDING SOLUTIONS COMPANY PROVIDING THE DESIGN,  
MANUFACTURE AND MARKETING OF INNOVATIVE BUILDING SYSTEM FOR  
INDUSTRIAL, COMMERCIAL, RESIDENTIAL, FLYOVERS & BRIDGES.

[www.mectech.net](http://www.mectech.net)

# CONTENTS

WELCOME TO MEC TECH CORPORATION LTD.	01
MESSAGE FROM MANAGING DIRECTOR	02
COMPANY INFORMATION	03
BENEFITS OF MEC TECH CLIENTS	04
OUR POLICY	05
MISSION, VISION & VALUES	06
DESIGN CODES	07
PRODUCTS	08
STANDARD PANEL COLORS	17
FACTORY VISUALS	18
SOME MAJOR MANUFACTURING MACHINES	19
ERECTION EQUIPMENTS	20
SOME OF OUR MAJOR COMPLETED PROJECTS	21



Content

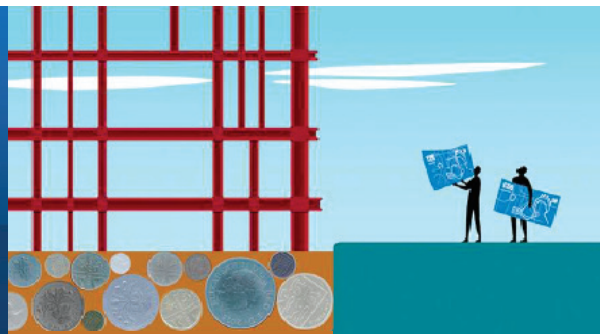



# WELCOME TO MEC TECH CORPORATION LTD.



MEC TECH is a rising company which is specialized in the pre-engineered steel buildings and heavy structural steel components for major construction projects. Our factory is well equipped with state of the art machineries which allows us to fabricate steel structure in line with national & international design codes. We have the necessary contemporary design and fabrication capabilities to encompass a wide range of steel structures including industrial shed/warehouse, commercial building, convention center, multi-storey building, mezzanine system, crane system, residential

building, bridge and aircraft hangar facilities. MEC TECH subscribes to the total support, that's why we maintain skilled manpower facilities which are consist of architects, engineers, quality surveyors, planning supervisors and skilled erection team. Combination of equipped machineries and skilled man power enables us to deliver a seamless construction service. Clients are always our first priority and we believe that our success comes from client's satisfaction. We strive to ensure that our commitments are kept.



I feel confident while sharing that MEC TECH remains on course to become a leading EPC (Engineering Procurement Construction) project contractor who are expertise specially in MEP since its establishment in 2004. For more than a decade, we have maintained a strong position in competitive market. This has been made possible by our entrepreneurial spirit, living up to commitments and unstinted support of stakeholders. Our emergence as MEC TECH group of companies is aligned with a vision of progressing up the value chain to a sustainable extent. This process of development shall remain under focus during the coming years. For us what matter most is customer satisfaction which we have to balance against our growth pattern. Our team members who have the spirit to push boundaries and of fostering a culture of accepting challenges. MEC TECH has completed many projects in the multi discipline of electro-mechanical field including Gas, HFO, Diesel based Power Generation & Distribution System, Industrial and Commercial Sector such as Composite, Spinning, Tobacco, Cement, Food & Beverage, Pharmaceuticals, HVAC, Fire Protection & Detection System. After successful completion of different projects over and above progress continuous in market value MEC TECH has recently devoted to make a significant effect in Pre-Engineered Steel structure field. In the coming years, we will continue to reinforce our successful track record. New contracts shall translate into improved efficiencies by re-mapping our internal process using best market practices. The challenges in the market continue but we look at them as opportunities to make ourself better. Our achievements have been hard-earned and what we learnt has immense value in terms of organizational growth. It is a matter of pride that the MEC TECH badge differentiates us from the ordinary. I pay tribute to our teams at every level for being a part of the MEC TECH family.

**Engr. Sk. Zana Alam**  
Managing Director

## MESSAGE FROM MANAGING DIRECTOR



# COMPANY INFORMATION

<b>Name of the Company</b>	: MEC Tech Corporation Ltd.
<b>Address</b>	: Plot # 2/6, Alba Tower (5 <sup>th</sup> Floor) Section # 11 (Mirpur 11 ½ Bus Stand) Pallabi, Mirpur, Dhaka-1216, Bangladesh
<b>Telephone</b>	: +88-02-8001577, +88-02-9028692
<b>Cell</b>	: +88-01613 244756, +88-01713 244745
<b>e-mail</b>	: info@mectech.net, zanaalambd@gmail.com
<b>Website</b>	: www.mectech.net
<b>Company Registration No</b>	: C-110403/13
<b>TIN Certificate No</b>	: 415615136048
<b>Trade License No</b>	: 02-01239
<b>Principal Bankers</b>	: Bank Asia Ltd., Mutual Trust Bank Ltd. United Commercial Bank Ltd.
<b>Factory Area</b>	: 30,000 sft.
<b>Address</b>	: Shaha Beliswar, Bathuli, Dhamrai, Dhaka
<b>Production Capacity</b>	: 15,000 MT/Year
<b>Field of Activities</b>	: Design, Shop Detail, Fabrication, Supply & Erection of Pre-Engineered Steel Buildings
<b>Managing Director</b>	: Engr. Sk. Zana Alam

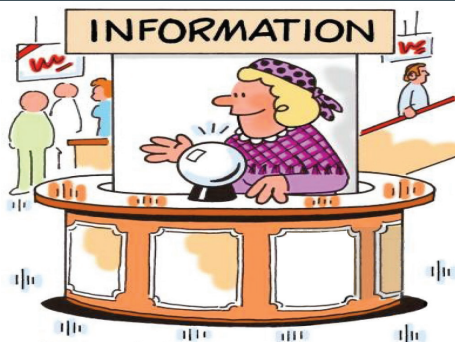

- MEC Tech Corporation Ltd. is always devoted to supply maximum grade materials to their client along with world class structure erection and ensure good relationship to them.
- Safe and cost effective solutions.
- MEC TECH provides design consultancy for steel and civil works.
- MEC TECH performs all types of steel work very efficiently and possible to handover the project in due time.
- Diversified steel structures and versatile product range.
- Highest quality steel production with shot blasting facilities.
- Precise fabrication using advanced fabricating machines.
- Installation/Erection with competence.
- Fastest Delivery.
- After sales service support.

We have a talented and experienced engineering team who would be very pleased to offer a completely free consultation and comprehensive quotation including proposal drawing in the shortest possible time frame.

We sincerely look forward to being of service to you and would be very pleased to respond to any inquiries you may have.



BENEFITS





## OUR POLICY

We, MEC Tech Corporation Ltd. are committed to the success of the design, production, supply & erection of Pre-Engineered Steel Buildings.

We shall exert every effort to the following in all our activities :

- ✓ Gaining the confidence and trust of our supervising bodies, employees, stakeholders, customers and the public through strict adherence to all applicable laws, regulations and best practices.
- ✓ Systematically monitoring, measuring, reviewing and protecting our environment by utilizing our taking effective actions to mitigate adverse risks and enhancing positive impacts on the Quality and Environment of all our activities.
- ✓ Protecting our environment by effectively utilizing our resources and reducing / preventing (as possible) the pollution that may be associated with MEC Tech Corporation Ltd. activities through effective waste management, recycling & reusing activities.

The above Policy provides the framework and sets the basis for establishing and reviewing our objectives at all relevant functions of MEC Tech Corporation Ltd. It will be reviewed periodically for continuing stability and suitability.



## MISSION

- ▶ To assist customers through the fundamentals.
- ▶ To the most visible aspect of their business with continuous emphasis on meet the needs for our clients, without losing sight on value.

## VISION

- ▶ To continue towards the growth of an increasingly discerning market & industry and achieving customer satisfaction not only for outstanding workmanship, but also quality design, concepts functionality and style.

## VALUES

- ▶ Emphasis on quality works as part of our corporate culture.
- ▶ Quality awareness and practice at all levels.
- ▶ Leadership by example and quality management.
- ▶ Providing the best to achieve client satisfaction with quality & service.
- ▶ Committed and dedicated to continuous quality improvement.
- ▶ Strive to be the best quality driven corporation in the industry.
- ▶ Lasting clients' satisfaction with quality & service.
- ▶ Leading edge in participative management and teamwork.





# DESIGN CODES

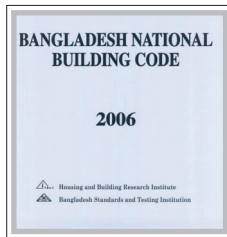

- **The buildings are designed in accordance with the following codes:**

- Bangladesh National Building Code (BNBC)
- International Building Code "IBC-2009"
- Metal Building Manufacturers Association (MBMA)
- 2006 Metal Building Systems Manual (MBSM)



- **ASCE-7 Minimum Design Loads for Buildings and other structures Latest Edition: 2005**

- American Society of Civil Engineers (ASCE)
- 2005 Manual of Steel Construction- Allowable Stress Design (ASD)
- 2003 Manual of Steel Construction- Load Reduction Factor Design (LRFD)

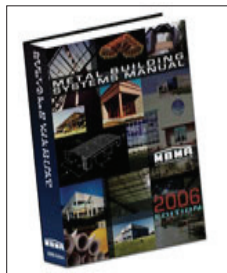

- **Structural Analysis, Design and Detailing is done by the aid of following Softwares:**

- STAAD. Pro V8i
- STAAD FOUNDATION 5.0
- ETABS Nonlinear v 9.5.0
- SAP-14
- AutoCAD 2007 & 2010
- Tekla Structures 17.0

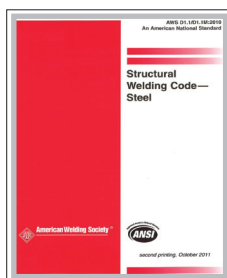

- **Cold formed members are designed in accordance with:**

- 2002 Edition of Cold Formed Steel Design Manual
- American Iron and Steel Institute (AISI)

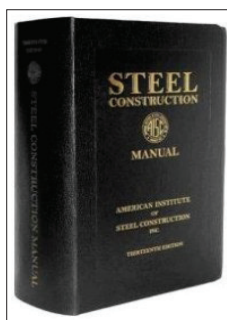

- **Welding is applied in accordance with:**

- American Welding society (AWS), Edition-2010

# PRODUCTS

## MATERIAL SOURCING:

Around 90% of the materials used in Pre-Engineered Steel Building by MEC TECH are imported from Japan, Korea, Taiwan, China and India.

The information about the imported products are as follows:

50 grade high strength MS plate sourcing from Nippon (Japan), Dongkuk /Posco (Korea)

80 grade colors sheet sourcing from SYSCO (Taiwan), TATA BlueScope (India)

50 grade decking sheet sourcing from Korea/Taiwan/China

8.8 grade High strength Nut-Bolt sourcing from China

Fasteners, Insulation and accessories sourcing from China.

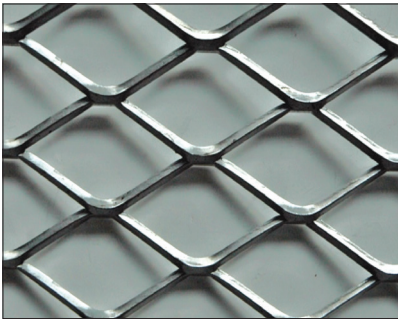

EXPANDED METAL

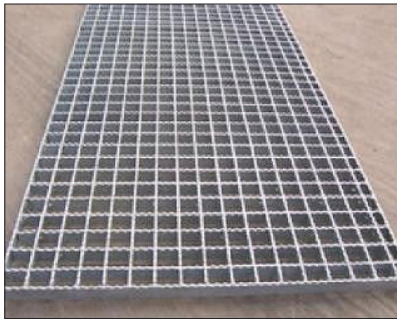

STEEL GRATING



SEALANTS



SELF DRILLING SCREW WITH EPDM RUBBER



HOT DIP GALVANIZED NUT- BOLT



ANCHOR BOLTS



# PRODUCTS

Clear Span Main Frame

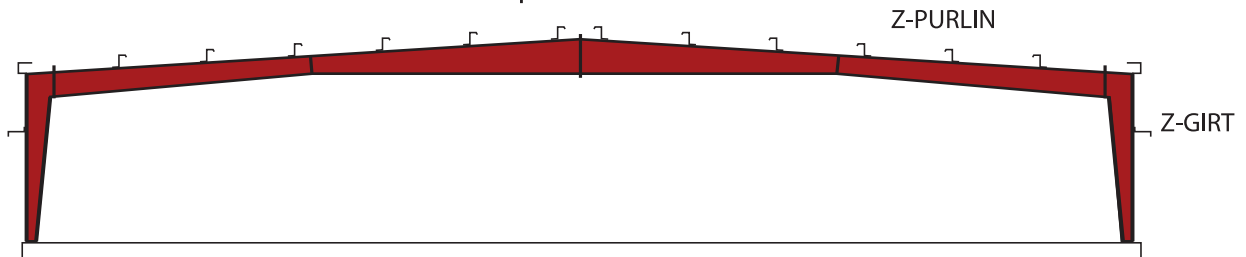

Modular Span one Interior Column

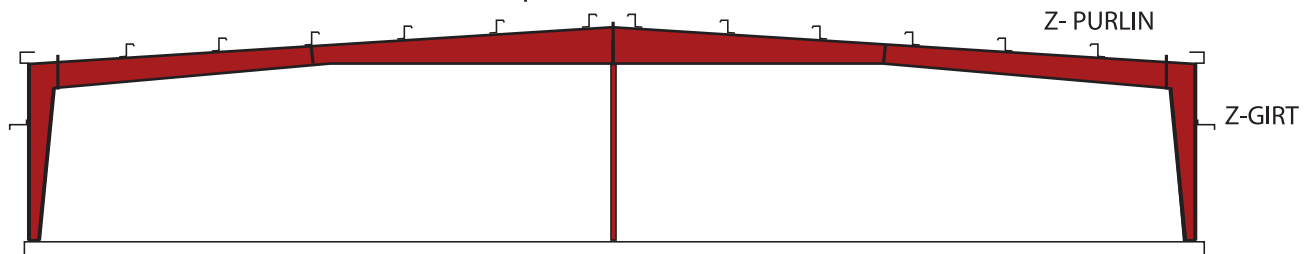

Modular Span two Interior Columns

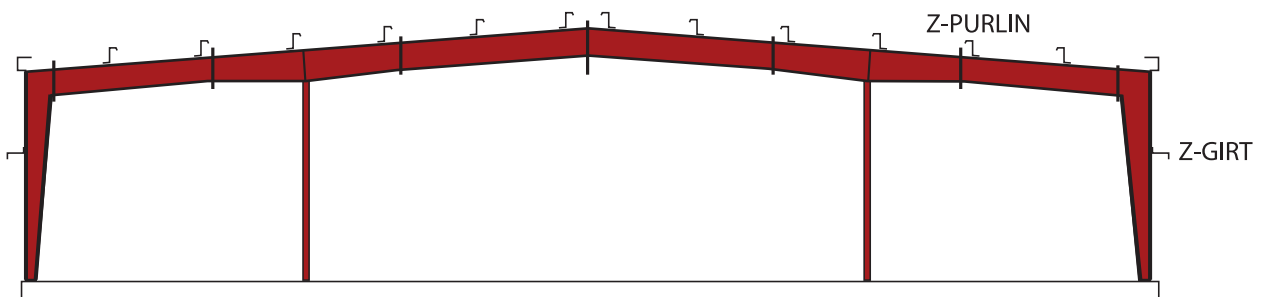

Modular Span three Interior Columns

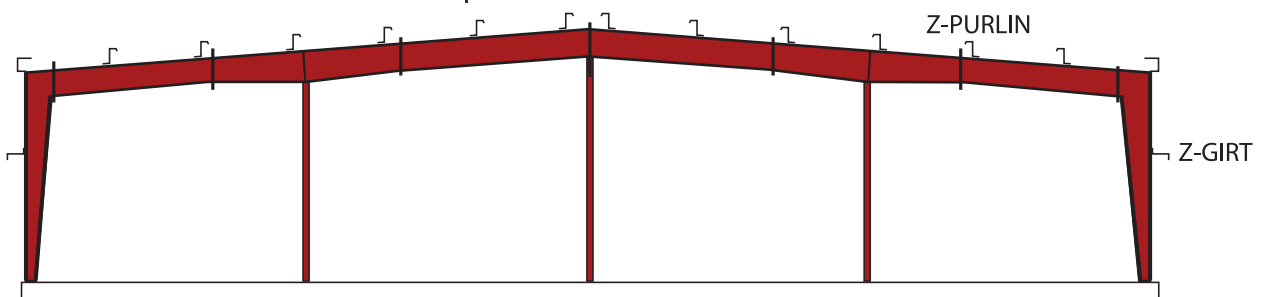

# PRODUCTS

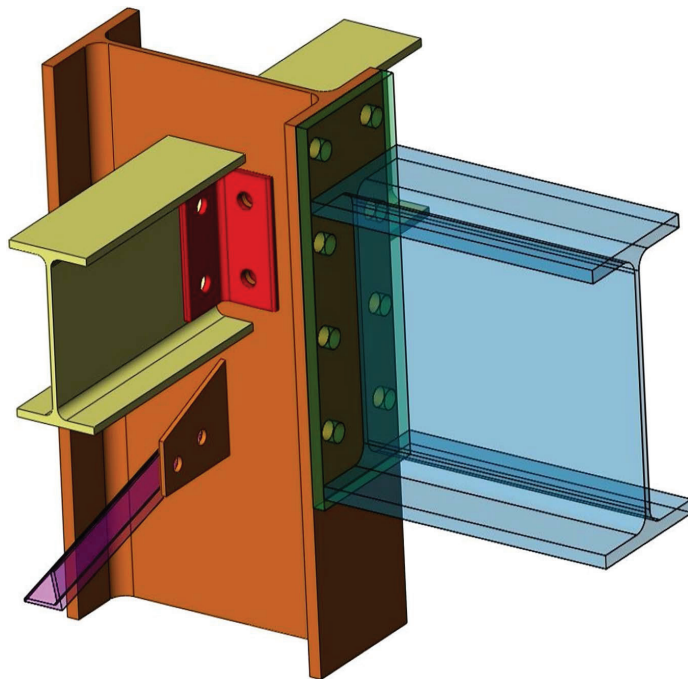
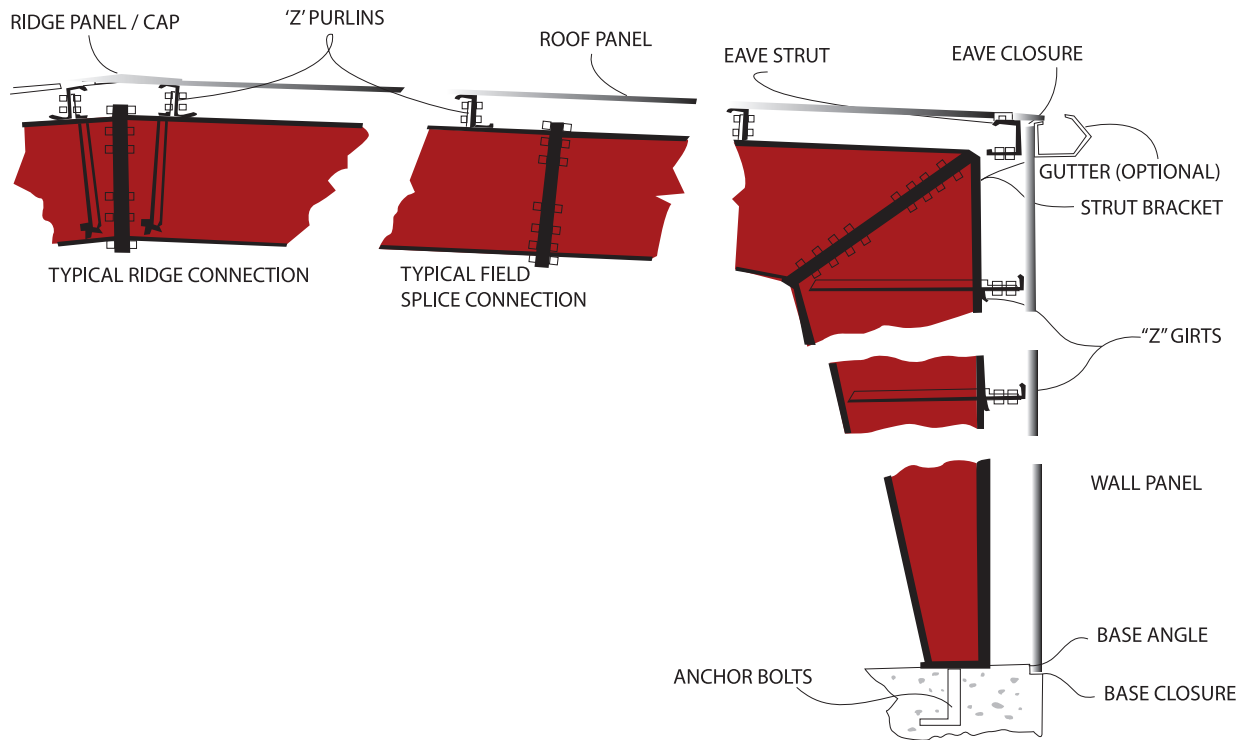

**CONNECTION**

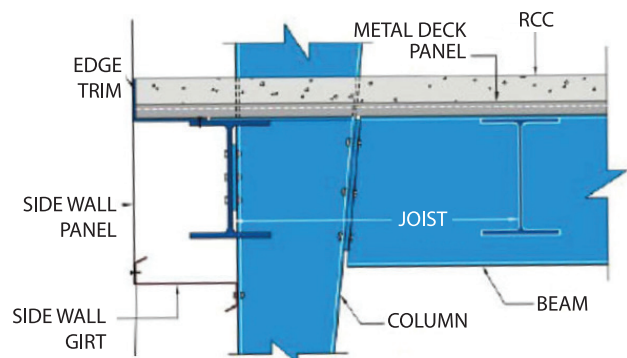

**BEAM CONNECTION TO COLUMN**

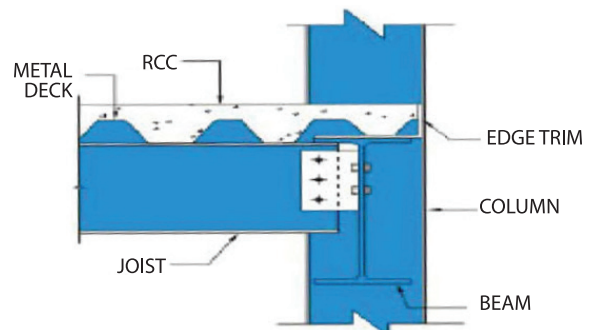

**JOIST CONNECTION TO COLUMN**



# PRODUCTS



PRE-ENGINEERED STEEL FRAME



HEAVY BUILT UP



CURVED BEAM



CASTELLATED BEAMS



OPEN WEB JOISTS FRAME



CURVED PEB FRAMES

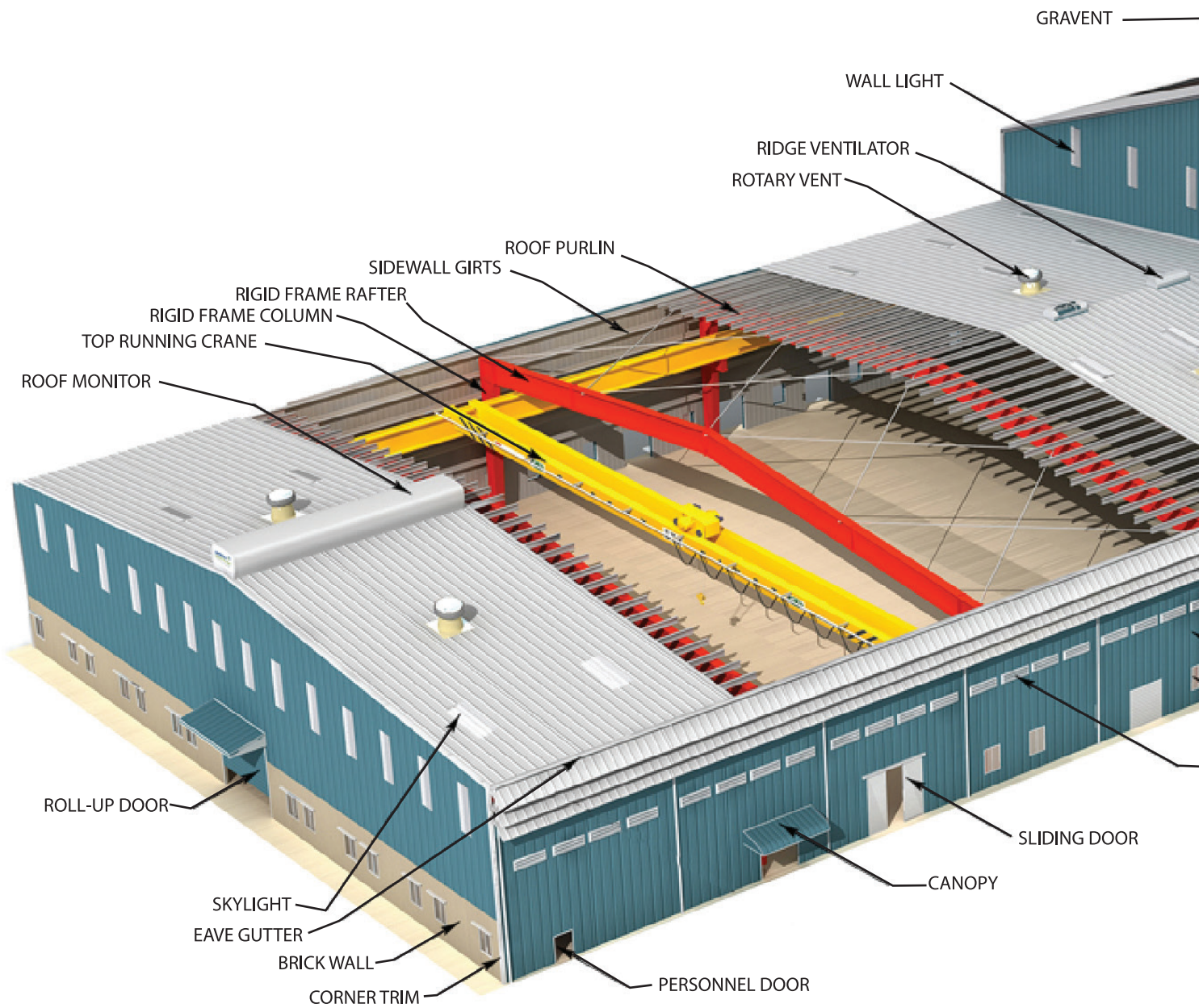



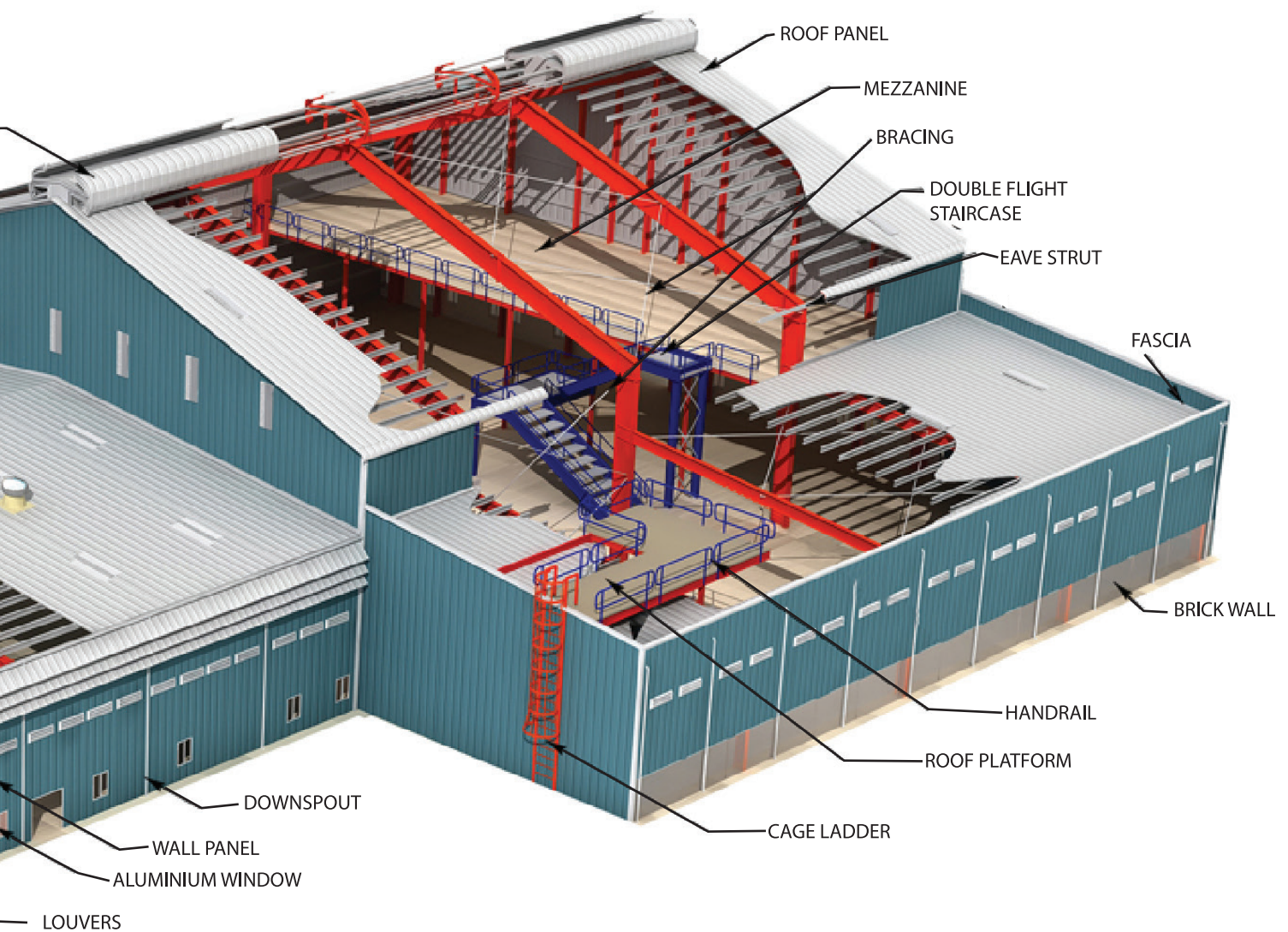

The Pre-Engineered Steel Building System is a building enclosure system that always includes a structural system and often includes roof and wall cladding. The general idea of the system is represented in the above diagram. The structural system consists of rigid frames that are fabricated from plate steel through a manufacturing process. These rigid frames consist of rafters/roof beams and columns. These frames span can be extended without intermediate supporting columns. The frames are spaced at intervals between similar/variable distances.

The Pre-Engineered Steel Building System is important because it very economically allows for the creation of large column-free enclosures. The best applications for the Pre-Engineered Steel Building System include industrial applications such as complex industrial facilities, warehouses and distribution centers. The system is also used in retail stores, shopping centers, hotels, auto dealerships, office complexes, airplane hangars, sports and entertainment arenas as well as schools, libraries, medical facilities and government buildings.

There are those who still believe that steel buildings are selected from a catalog of standard designs based on the size of the building. In fact the buildings are custom-engineered to specific dimensions, structural criteria and materials in accordance with local building codes. The Pre-Engineered Steel Building System has evolved over the years into assemblages of structural elements that work together to provide a very efficient system. Each part of the system is designed to precisely fit together which transforms into buildings that can be built with greater speed and accuracy than is possible using conventional methods. Additionally, systems construction offers significant cost and performance advantages over conventional construction methods including lower life cycle costs for greater ROI (return on investment), unlimited design flexibility and sustainability attributes such as 100% recycled steel.



# PRODUCTS



DECK PANEL

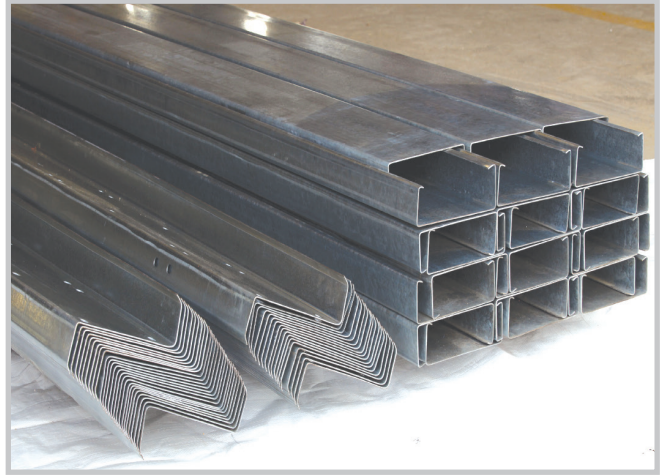

C - PURLIN & Z - PURLIN



I-BEAM



H-BEAM



MEZZANINE FLOOR



CRANE



# PRODUCTS



TRANSPARENT SHEET



CANOPY

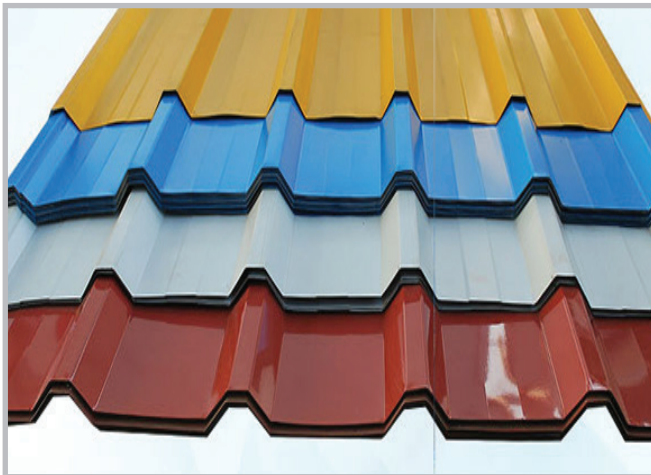

PROFILE SHEET



CLADDING



WALKWAY



STAIRCASE



# PRODUCTS



SLIDING WINDOW



LOUVER



SLIDING DOOR



ROLL UP DOOR



PERSONNEL DOOR

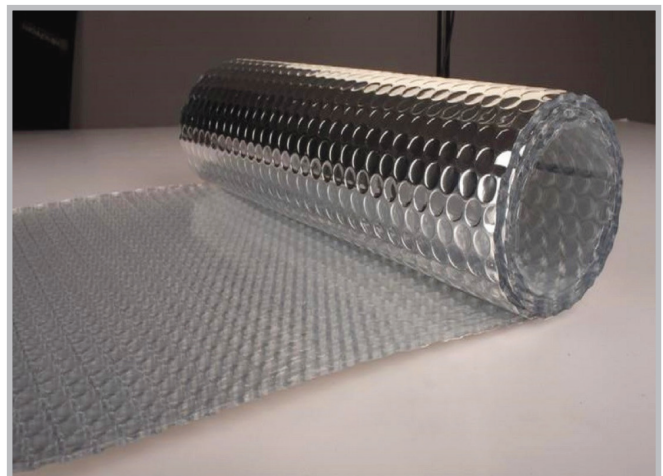

INSULATION



## STANDARD PANEL COLORS



Headland



Pale Eucalypt

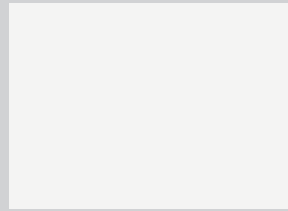

Surfmist



Cottage Green



Aquamarine

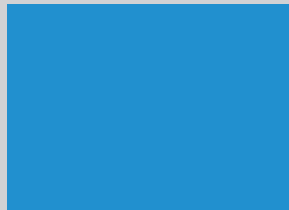

Sky Blue



Torres Blue



Toba Blue



# FACTORY VISUALS





## SOME MAJOR MANUFACTURING MACHINES

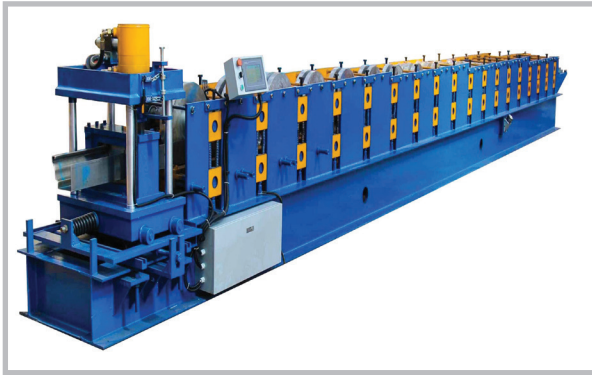

C & Z PURLIN ROLL FORMING MACHINE



DECK PANEL ROLL FORMING MACHINE

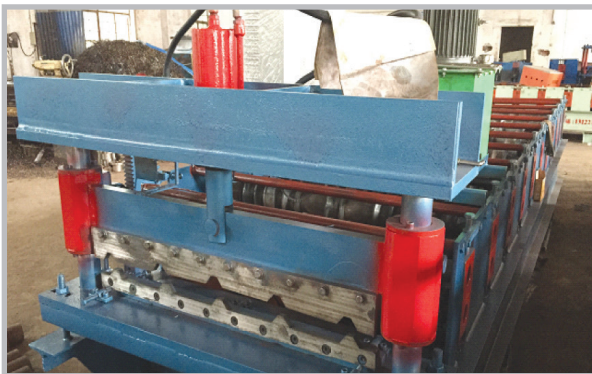

ROOF & WALL PANEL ROLL FORMING MACHINE



CNC PLASMA FRAME CUTTING MACHINE



IRON WORKER



SHARING MACHINE



AUTO WELDING MACHINE



SHOT BLASTING MACHINE



# ERECTION EQUIPMENTS



## SOME OF OUR MAJOR COMPLETED PROJECTS



102 MW HFO POWER PLANT  
Project : Digital Power & Associates Ltd. Narayangonj



10 MW INDUSTRIAL POWER PLANT  
Project : Akij Food & Beverage Ltd. Unit-2, Chhatok, Sylhet



50 MW GAS BESED RENTAL POWER PLANT  
Project : Energy Prima Ltd. Fenchugonj, Sylhet

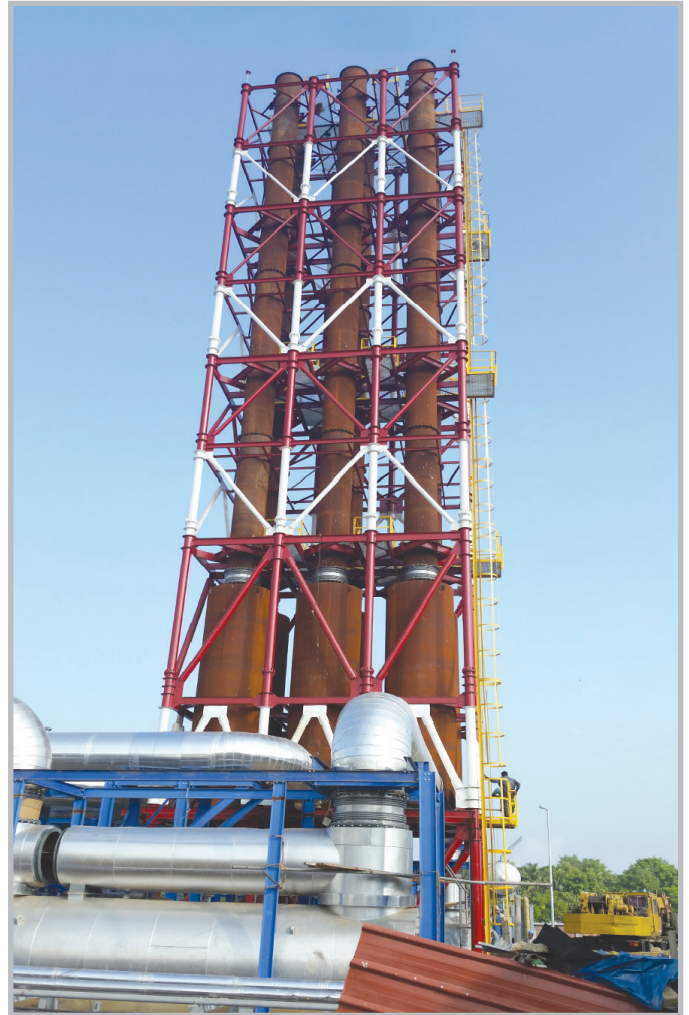

52 MW HFO POWER PLANT  
Project : Lakdhanavi Ltd. Comilla



102 MW HFO POWER PLANT  
Project : Digital Power & Associates Ltd. Narayangonj



## SOME OF OUR MAJOR COMPLETED PROJECTS



100 MW HFO POWER PLANT  
Project : Orion Power Meghnaghat Ltd. Meghnaghat, Narayangonj



100 MW HFO POWER PLANT  
Project: Digital Power & Associates Ltd. Narayangonj



100 MW HFO POWER PLANT  
Project: Dutch Bangla Power Plant Ltd. Narayangonj



100 MW HFO POWER PLANT  
Project: Orion Power Meghnaghat Ltd. Meghnaghat, Narayangonj



100 MW HFO POWER PLANT  
Project: Dutch Bangla Power Plant Ltd. Narayangonj



# SOME OF OUR MAJOR COMPLETED PROJECTS



ECPVL 108 MW HFO POWER PLANT Project: Kolagoan, Chittagong



ECPVL 108 MW HFO POWER PLANT Project: Kolagoan, Chittagong



UTILITY BRIDGE  
Project: Digital Power & Associates Ltd. Narayangonj



AFBL  
Project : Akij Food & Beverage Ltd. Unit-2, Dhamrai, Dhaka



# SOME OF OUR MAJOR COMPLETED PROJECTS



ASHUGONJ 450 MW CCPP (NORTH) Power Plant Ltd. Brahmanbaria



ASHUGONJ 450 MW CCPP (NORTH)  
Power Plant Ltd. Brahmanbaria



7.5 MW INDUSTRIAL POWER PLANT  
Project: Akij Textile Mills Ltd.



WATER TREATMENT PLANT  
Project : Consumer Knitex Ltd. Valuka, Mymensingh



CENTRAL AIR CONDITIONING WORK  
Project : Dhaka Tobacco Industries, Tongi, Gazipur



## HEAD OFFICE

Plot # 2/6, Alba Tower (5<sup>th</sup> Floor)  
Section # 11 (Mirpur 11 ½ Bus Stand), Pallabi  
Dhaka-1216, Bangladesh  
Phone: +88-02-8001577, +88-02-9028692  
Cell : +88-01613 244756, +88-01713 244745  
E-mail: info@mectech.net, zanaalambd@gmail.com  
Website: www.mectech.net

## CHITTAGONG OFFICE

Hazi Para, Singapore Market  
Room No : 442, Level -3, Unit-2  
Agrabad, Chittagong  
Cell: +88-01613 244758

## FACTORY

Shaha Beliswar, Bathuli, Dhamrai, Dhaka

## SERVICE CENTER

F-10, Main Road, Eastern Housing (Phase-2)  
Pallabi, Mirpur #12, Dhaka-1216

## WARE HOUSE

Konda, Bongaon, Savar , Dhaka





# STEEL STRUCTURE

## SISTER CONCERN

MEC Tech Solution (BD) Ltd.	MEC Tech Logistic Service
MEC Tech Engineering Service Ltd.	MEC Tech Trading

